

Figure 628 0G KHS temperature sensor valve Pt 1000 with male thread on both sides

Technical properties
Pt 1000 4-conductor measuring element, tolerance class A according to DIN EN 60751
Connection line 1 m, 4 x 0.22 mm ² , with wire-end sleeves
operating temperature range 0 - 105°C
Protective sleeve, sensor ø 6 mm
1.4571 stainless steel sensor
Suitable for BMS and KEMPER KHS-Logic control system Made completely from gunmetal
Sensor in medium



628 0G KHS temperature sensor valve Pt 1000 including resistance thermometer

Product description / Tender text
KEMPER KHS temperature sensor valve Pt 1000 , as interface to KHS-Logic control system or to I&C system, low-pressure loss housing with full flow, completely in gunmetal, resistance against aggressive water, stagnant-zone-free, with permanently installed Pt 1000 resistance thermometer with 4-conductor engineering, tolerance class DIN EN 60758 Class A, stainless steel protective sleeve 6 mm, 1 m connection cable, 4 x 0.22 mm ² , with wire-end sleeves, rated pressure PN 16,
both sides with male thread to universal connection to fittings for copper, steel, stainless steel and multilayer duplex tubes, from DN 15 (3/4") to DN 50 (2 3/8")

Dimensions							
Nominal width	DN	15	20	25	32	40	50
Overall height (H1)	mm	65	68	70,5	78	79	88,5
Length (L)	mm	65	67	72	77	82	90
Length (L1)	mm	60	60	70	80	80	80
Connection dimension (A1)		G 3/4	G 1	G 1 1/4	G 1 1/2	G 1 3/4	G 2 3/8
Connection dimension (A2)		G 3/4	G 1	G 1 1/4	G 1 1/2	G 1 3/4	G 2 3/8

Materials	
Housing	Gunmetal
Plug stoppers	Gunmetal
Sensor	Niro
Flat gaskets	EPDM
Gaskets	EPDM
Sensor	Stainless steel 1.4571

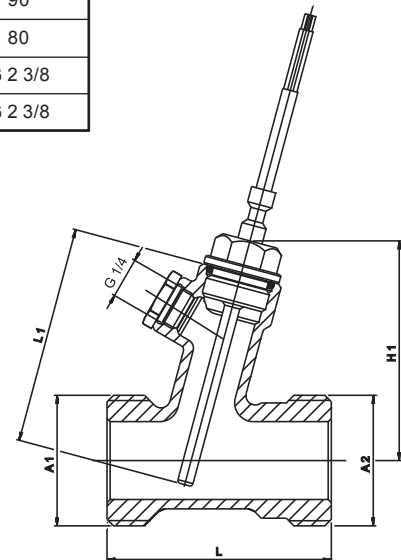

Technical information
The KEMPER KHS Pt1000 temperature sensor valve is used in hygiene systems to register system temperatures in the CDW and WDW areas. That means temperature-controlled plant processes can be activated from a central, computerised control centre. Centralising the messages about temperature conditions in cold and warm water and automating stop valves helps implement cost effective facility management and drinking water hygiene.