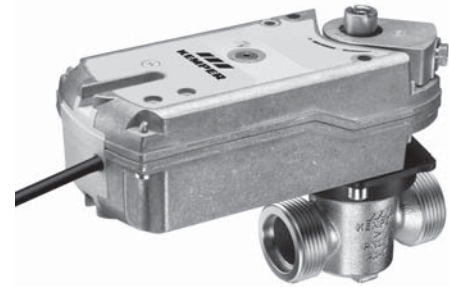

**Figure 686 01 KHS-VAV-plus Maximum flow isolating ball valve with spring-reset servo drive, 24 Volts DC**

Technical properties
Medium-contacting parts made of gunmetal
Removable head part 'Top Entry'
VAV DIN-/DVGW approved according to W 570 and DIN EN 13828
Pressure-impact free operation
Pressure stage PN 16
Simple maintenance when installed
Stagnant-zone-free
Connection to the KHS-Logic control system with position feedback
0...10 V position feedback, 0 V = drive closed / 10 V = drive completely open
Supply voltage 24 V DC, Connection cable 0.9 m, 4 x 0.75 mm <sup>2</sup>
Power consumption 2.5 V / 3.5 VA
Maintenance-free transmission
Perm. ambient temperature up to 55°C
Protection class: IP54
Valve closes automatically during power failures



**686 01 KHS-VAV plus Maximum flow isolating ball valve with spring-reset servo drive for KHS-Logic, 24 Volts**

Product description / Tender text
<b>KEMPER KHS-VAV-plus Maximum flow isolating ball valve with spring-reset servo drive for KHS-Logic control system,</b> especially suitable for the KEMPER Hygiene System KHS, consisting of:
<b>Maximum flow isolating ball valve,</b> in accordance with DIN EN 13828, corresponds to the drinking water hygiene requirements according to DVGW W 570, made entirely from gunmetal, resistant against aggressive water, brass-free in areas that touch fluids, with maintenance-free spindle sealing' Top Entry' head part can be removed from top, made with EPDM gasket body with rotating-supported gunmetal closing body, stagnant-zone-free, can be rotated 90°, with DIN/DVGW and soundproofing certificate, rated pressure PN 16 and
<b>Servo drive,</b> for connection to the KHS-Logic control system as 2-point controller with valve feedback completely open, <b>Supply voltage 24 V DC,</b> runtime motor 90° 90 sec., closing through spring 15 sec., resets in case of voltage drops, electronic torque-dependent switch-off, with self-centring lock lever and fixed flange for installation on the valve, hexagonal spanner for manual adjustment or spring-lift, connection cable 0.9 m, 4 x 0.75 mm <sup>2</sup> ,
both sides with male thread for universal connection to fittings for copper, steel, stainless steel and multilayer duplex tube, from DN 15 (3/4") to DN 32 (1 1/2")

A 24 V DC to AC transformer module needs to be integrated for operation with 24 V AC (see next page).

Dimensions					
Nominal width	DN	15	20	25	32
Overall height (H1)	mm	135	135	140,5	146,5
Overall height (H2)	mm	110	110	112,5	115,5
Length (L1)	mm	68	73	88	93
Length (L2)	mm	150,3	150,3	150,3	150,3
Connection dimension (A1)		G 3/4	G 1	G 1 1/4	G 1 1/2
Depth (T1)	mm	81	81	81	81
Diameter (d1)	mm	18	22,5	29	35

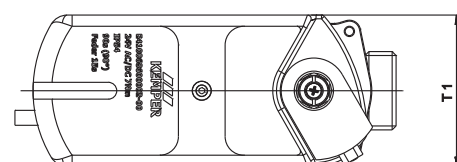
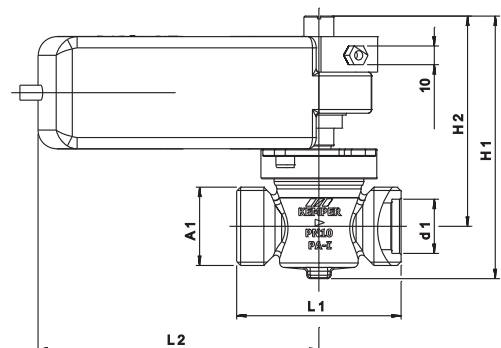

Materials	
Housing, interior head part	Gunmetal
Spindle	Gunmetal
Seal element	EPDM
Coupling	Brass
Drive housing	Light-metal casting
Axis adapter	Steel
Flange adapter	PA

**Figure 686 01 KHS-VAV-plus Maximum flow isolating ball valve with spring-reset servo drive, 24 Volts DC**

Technical information
<p><b>Area of application</b></p> <ul style="list-style-type: none"> <li>- Install the KHS-VAV-plus in drinking water installations for the KEMPER hygiene system to maintain the intended use in CDW and WDW operation. Install as a terminal flushing valve in stagnating drinking waterlines.</li> <li>- If the power fails during flushing, the valve automatically closes in connection with the KHS-Logic control system (closes currentless).</li> <li>- The valve can be used together with the KEMPER KHS Logic control system for building I&amp;C systems. It is referred to as the B-Valve or C-Valve in the KHS-Logic system controller.</li> <li>- The valve is not suited to restricting volume flows, so its intended use is solely for FULL OPENING or FULL CLOSING.</li> </ul> <p><b>Maintenance</b></p> <ul style="list-style-type: none"> <li>- According to DIN 1988-1, the operator has to inspect annually.</li> <li>- Please refer to the installation and operating instructions for further information.</li> </ul>

**Figure 686 01 001 24 V AC Transformer Module for KHS VAV-Plus Figure 686 01**

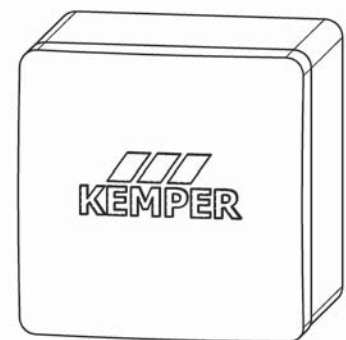

**KEMPER transformer module for 24 V AC drive operation**

Product Description / Tender Text
<p>KEMPER transformer module with circuit board and IP 65 casing for operating the KHS-VAV maximum flow stop valve with 24V spring reset servomotor, Figure 686 01, with 24 V AC power supply, casing 80 x 80 x 75, 2x M16 screwed cable gland</p>

Technical Information
<p>The KEMPER transformer module needs to be installed in the direct vicinity of the drive. The transformer module is only applicable for the Figure 686 01 drive.</p>

