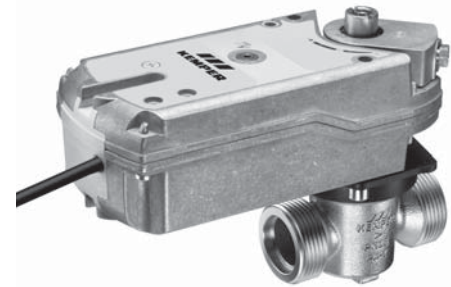

**Figure 686 05 KHS-VAV-plus Maximum flow isolating ball valve with spring-reset servo drive, 230 Volts**

Technical properties
Medium-contacting parts made of gunmetal
Removable head part 'Top Entry'
VAV DIN-/DVGW approved according to W 570 and DIN EN 13828
Pressure-impact free operation
Pressure stage PN 16
Simple maintenance when installed
Stagnant-zone-free
Connection as a 2-point controller
Supply voltage 230 V, Connection cable 1.2 m, 2 x 0.75 mm <sup>2</sup>
maintenance-free transmission
Perm. ambient temperature up to 55 °C
Protection class: IP54
Valve closes automatically during voltage drops



**686 05 KHS-VAV plus Maximum flow isolating ball valve with spring-reset servo drive for KHS Timer, 230 Volts**

Product description / Tender text
<b>KEMPER KHS-VAV Maximum flow isolating ball valve with spring-reset servo drive</b> , consisting of:
<b>Maximum flow isolating ball valve</b> , compliant with DIN EN 13828 corresponds to the drinking water hygiene requirements according to DVGW W 570, made entirely from gunmetal, resistant against aggressive water, brass-free in areas that touch fluids, with maintenance-free spindle sealing, 'Top Entry' head part can be removed from top, made with EPDM gasket body with rotating-supported gunmetal closing body, stagnant-zone-free, can be rotated 90°, with DIN/DVGW and soundproofing certificate, rated pressure PN 16 and
<b>Servo drive</b> , for controller with switching output 2-point control, <b>supply voltage 230 V</b> , runtime Motor 90° 90 sec., spring 15 sec., reset during voltage drop, electronic torque-dependent switch-off with self-centring lock lever and fixed flange for mounting on the valve, hexagonal spanner for manual adjustment or spring-lift, connection cable 0.9 m, 2 x 0.75 mm <sup>2</sup> ,
both sides with male thread for universal connection to fittings for copper, steel, stainless steel and multilayer duplex tubes, from DN 15 (3/4") to DN 32 (1 1/2")

- For more information please see reverse side

Dimensions					
Nominal width	DN	15	20	25	32
Overall height (H1)	mm	135	135	140,5	146,5
Overall height (H2)	mm	110	110	112,5	115,5
Length (L1)	mm	68	73	88	93
Length (L2)	mm	150,3	150,3	150,3	150,3
Connection dimension (A1)		G 3/4	G 1	G 1 1/4	G 1 1/2
Depth (T1)	mm	81	81	81	81
Diameter (d1)	mm	18	22,5	29	35

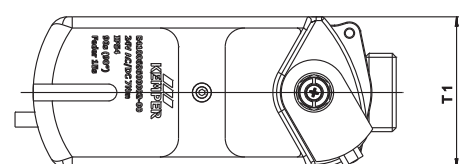
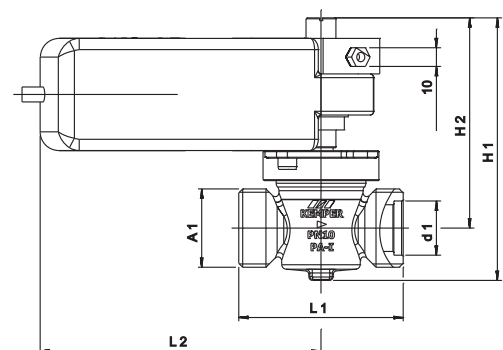

Materials	
Housing, interior head part	Gunmetal
Spindle	Gunmetal
Seal element	EPDM
Coupling	Brass
Drive housing	Light-metal casting
Axis adapter	Steel
Flange adapter	PA

**Figure 686 05 KHS-VAV-plus Maximum flow isolating ball valve with spring-reset servo drive, 230 Volts**

**Technical information**

**Area of application**

- Install the KHS-VAV-plus in drinking water installations for the KEMPER hygiene system to maintain the intended use in CDW and WDW operation and as a terminal flushing valve in stagnating drinking water lines.
- If power fails during flushing, the valve automatically closes (currentless closing).
- Triggers the valve via the BMS or with the KEMPER KHS timer set.

**Maintenance**

- According to DIN 1988-1, the operator has to inspect annually.
- Please refer to the installation and operating instructions for further information.