

**Figure 687 KHS orifice plate**

**Technical properties**  
 Orifice plate for KHS-VAV-plus to maintain the flow rate of max. 5 m/s in the flush line.  
 The outlet of the orifice plate is inserted into the KHS-VAV-plus.



**687 Orifice plate**

**Product description / Tender text**  
**KEMPER orifice plate for KHS-VAV-plus Maximum flow isolating ball valve with spring-reset servo drive**, for limiting the drain flow by inserting on outlet of the KHS-VAV-plus Type B/C, made entirely of gunmetal, reliably resistant to aggressive water,  
**Figure 687 05 015** Nominal width DN 15, diameter 5 mm  
**Figure 687 08 020** Nominal width DN 20, diameter 8 mm  
**Figure 687 09 020** Nominal width DN 20, diameter 9 mm  
**Figure 687 10 020** Nominal width DN 20, diameter 10 mm  
**Figure 687 11 020** Nominal width DN 20, diameter 11 mm  
**Figure 687 12 025** Nominal width DN 25, diameter 12 mm  
**Figure 687 13 025** Nominal width DN 25, diameter 13 mm  
**Figure 687 14 025** Nominal width DN 25, diameter 14 mm  
**Figure 687 15 025** Nominal width DN 25, diameter 15 mm  
**Figure 687 16 032** Nominal width DN 32, diameter 16 mm  
**Figure 687 17 032** Nominal width DN 32, diameter 17 mm

**Dimensions**

Nominal width	DN	15				20				25				32	
		mm	mm	mm	mm	mm	mm	mm	mm	mm	mm	mm	mm	mm	mm
A-diameter (d)	mm	18	22,5	22,5	22,5	22,5	29	29	29	29	35	35			
I-diameter (d1)	mm	5	8	9	10	11	12	13	14	15	16	17			
Thickness (s)	mm	5	5	5	5	5	5	5	5	5	5	5			
Figure no.		68705015	68708020	68709020	68710020	68711020	68712025	68713025	68714025	68715025	68716032	68717032			

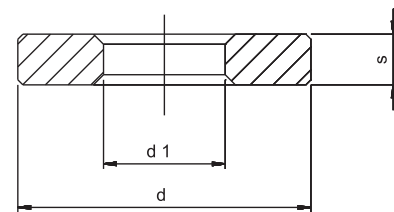

**Materials**

Orifice plate	Gunmetal
---------------	----------

**Technical information**  
**Area of application**  
 The KHS-orifice plates are used to reduce the flushing volume currents in terminal flushing valves (KHS-VAV-plus Maximum flow isolating ball valve with spring-reset servodrive). Depending on the flush line layout, high flow velocities can arise during planned flushing. So when calculating with the Dendrit software, the matching orifice panels for each VAV-plus-valve with spring-reset are already designed in the forefront for ca. 3 m/s.  
 Please note that the orifice plates can only be inserted in the outlet side in the intended enclosure.